



LuK Service Info

Part Nr. 500 1292 40 – PTO BEARING

Art.-Nr.: 500 1292 40



TB1073

**New product / Neues Produkt /
Nouveau produit / Nuevo produc-
to / Nuovo prodotto**

As a technology partner to many of the world's leading tractor producers, Schaeffler is at the forefront of clutch design and manufacturing. LuK can now offer an improved bearing, designed solely for use on Safety P.T.O. Single & Dual clutch systems, that delivers improved reliability and OE quality in an aftermarket product.

The P.T.O. release system on a Safety P.T.O. clutch works in the opposite way to that on a standard dual clutch.

During clutch engagement the bearing is held in constant contact with the clutch, which results in higher release loadings and operating temperatures. LuK's new 500 1292 40 C3 fit type bearing contains an improved high specification grease designed to more effectively withstand these increased demands.

The 500 1292 40 bearing is used in Safety P.T.O. clutch systems specified by Case-IH, John Deere, New Holland (Fiat) & Steyr.



Single release bearing assembly

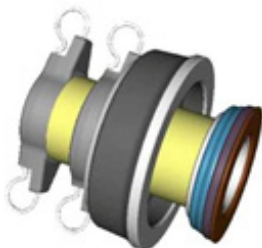

Dual release bearing assembly



500 1292 40

Call : +44 (0) 1432 264264
vehiclelifetimesolutions.schaeffler.com

SCHAEFFLER
REP>XPERT