

to fit:

Various makes and models

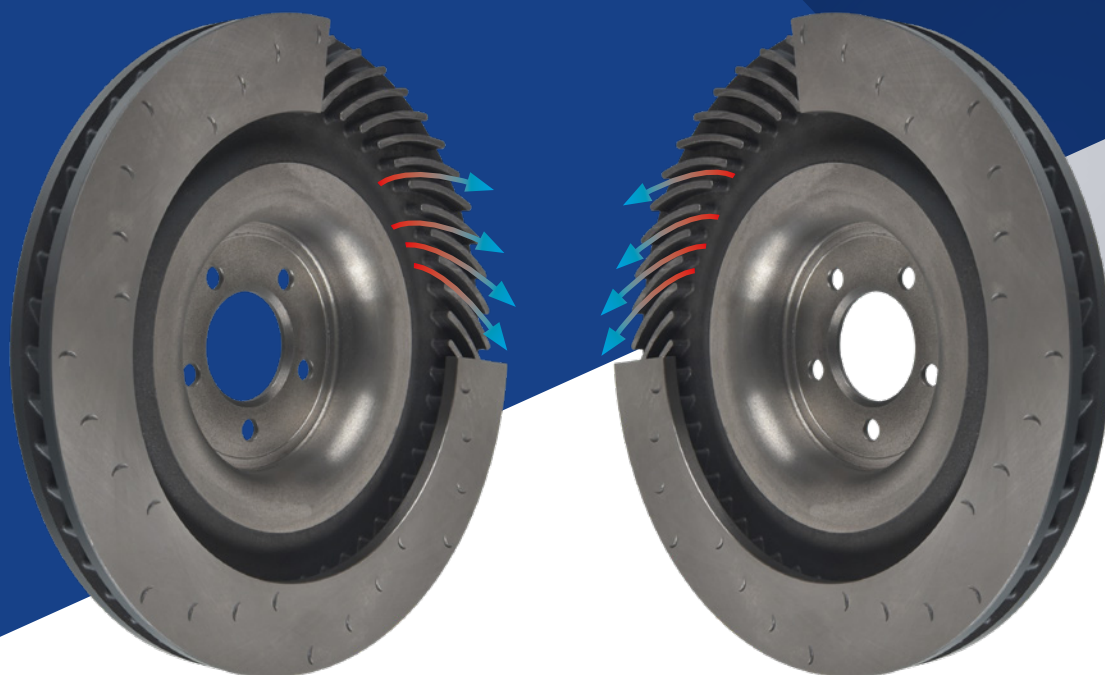

EN

Directional vented brake discs

Brake disc design is more than skin deep and the internal layout and construction of vented brake discs is particularly important for temperature control.

There are many design variations of the vented section to maximise the cooling effect, which include, pillar, column and curved column cooling vanes.

These designs allow the brake disc to draw in air through the casting to dissipate heat, faster than is possible with a solid brake disc.

Directional brake discs are designed with angled cooling vanes to maximise this cooling effect. They are more commonly fitted to high performance models and it is important to ensure the original braking specification is maintained by using the correct specification parts, fitted in the right way.

Each brake disc must be installed onto the correct side of each axle, with the vanes curved rearwards from the hub to enable air to be pulled into the centre of the hub, which enables this feature to function appropriately.

Each Blue Print brake disc with this ventilation feature has a different part number denoting the left hand or right hand brake disc and is individually packed.

However, to improve identification before fitting, the outer periphery of the disc and the box label are marked with a "LH" or "RH" indicating the left hand or right hand of the vehicle, when viewed from the driver's seat, in order to assist with an error free fitment.

For more technical information please visit: partsfinder.bilsteingroup.com