



INSTALLATION MANUAL

AS-2969

Arnott New Rear Left Air Strut (Comfort)
Bentley Continental GT & Flying Spur



INSTALLATION VIDEO

<https://bit.ly/46hgTOG>



Engineered to Ride, Built to Last®

CONGRATULATIONS ON YOUR PURCHASE OF AN ARNOTT® SUSPENSION PRODUCT

WE AT ARNOTT LLC ARE PROUD TO OFFER A HIGH QUALITY PRODUCT WITH ALL THE TECHNICAL SUPPORT YOU NEED. THANK YOU FOR YOUR CONFIDENCE IN US AND OUR PRODUCT.

Proper installation is essential to experience and appreciate the benefits of this system. Please take a moment to review these installation instructions before you begin to install these components on your vehicle. The removal and installation of air suspension products should only be performed by a fully qualified and certified automotive professional.

It is equally important to be aware of all necessary safety measures while installing your new Air Suspension System. This includes proper lifting and immobilizing of the vehicle and isolation of any stored energy to prevent personal injury or property damage.

GENERAL INFORMATION

Reading this manual signifies your agreement to the terms of the general release, waiver of liability, and hold harmless agreement, the full text of which is available at www.arnottsuspension.com and www.arnotteurope.com.



WARNING:

The air suspension system is under pressure (up to 10 bar, or 150 lbf/in). Verify pressure has been relieved and disconnect power to the air suspension system prior to disassembly. Do not allow dirt or grease to enter the system. Always wear standard hand, ear, and eye protection when servicing the air suspension system.

- Not to be stored below 5°F (-15°C) and above 122°F (50°C).
- Avoid damage to air lines and cables.
- Removal and installation is only to be performed by fully qualified personnel.
- Use car manufacturer's diagnostic software.

CAUTION:

Damage to the vehicle and air suspension system can be incurred if work is carried out in a manner other than specified in the instructions or in a different sequence.

To avoid the possibility of short circuits while working with electric components, consult your owner's manual on how to disconnect your battery.

Consult your vehicle owner's manual, service manual, or car dealer for the correct jacking points on your vehicle and for additional care, safety and maintenance instructions. Under no circumstances should any work be completed underneath the vehicle if it is not adequately supported, as serious injuries and death can occur.

For vehicles with a "Closed Air Supply System," replacement of components requires proper adherence to procedures set forth within OE servicing literature. Failure to comply with the OE prescribed procedures can result in component damage and/or failure.

AIR STRUT REMOVAL

1. Set the steering to straight ahead.
2. Raise the vehicle.
3. Remove the applicable rear wheel. (Figure 1)



FIGURE 1

4. Remove the fender well cover to access the rear strut. (Figure 2)



FIGURE 2

5. Locate and disconnect the electrical connection at the top of the strut. (Figures 3, 4)



FIGURE 3



FIGURE 4

6. Disconnect the air line and remove the air line fitting. (Figures 5, 6, 7)



FIGURE 5



FIGURE 6

AIR LINE FITTING REMOVAL



Prior to inserting the existing air line into the new air strut you will need to remove the old original equipment air line fitting and discard.

NOTE:

Scratches and/or deep cuts in the air line can result in possible leaks. Inspect the air line before insertion. Air line needs to be replaced if damaged.

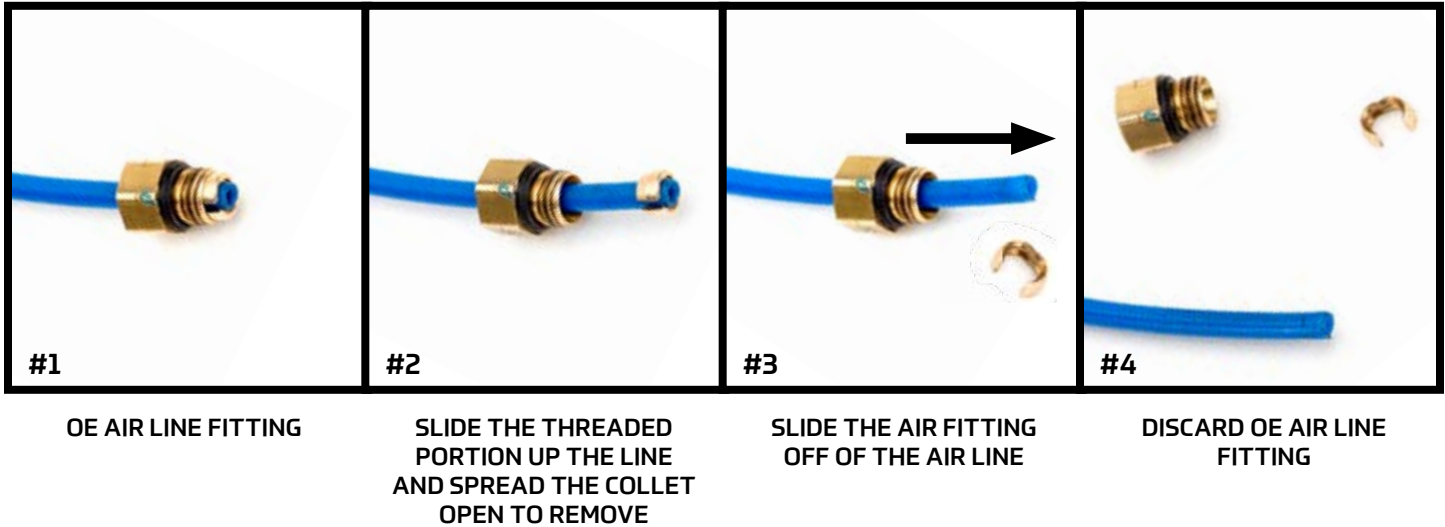

FIGURE 7

7. Remove the three (3) top bolts securing the strut to the vehicle. (Figure 8)



FIGURE 8

8. If present, remove the retention clip. (Figure 9)



FIGURE 9

9. Disconnect the electrical connection at the bottom of the strut. (Figure 10, 11)



FIGURE 10



FIGURE 11

10. Remove the bottom strut bolt. (Figure 12)



FIGURE 12

11. Disconnect the brake line bracket and ride height sensor. (Figures 13, 14)



FIGURE 13



FIGURE 14

12. Remove the sway bar bolt. (Figures 15, 16)

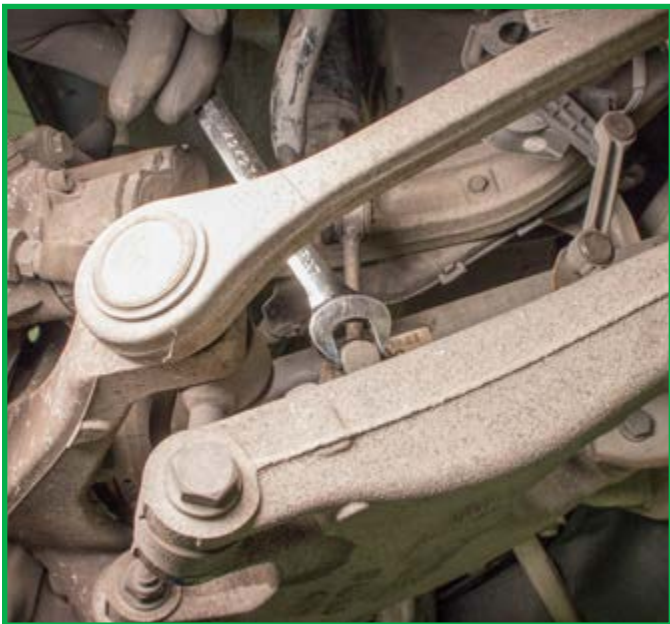

FIGURE 15

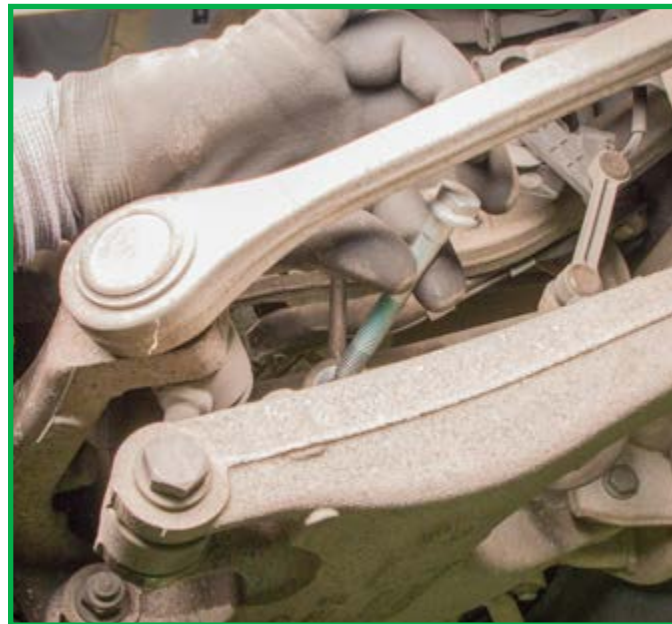

FIGURE 16

13. Using a breaker bar for leverage, lift the strut up and over the upper control arm. (Figure 17)



FIGURE 17

14. Remove the strut from the vehicle. (Figure 18)



FIGURE 18

15. Removal complete.

AIR STRUT INSTALLATION



WARNING:

Tighten all nuts and bolts to the manufacturer's specifications during the installation process.



WARNING:

Do not remove the air fitting from the air strut. Doing so may cause damage and/or void warranty.

1. Installation is in the reverse order of air strut removal. Adhere to all of the manufacturer's specifications for torque values. Follow the Shipping Pin Removal and Air Line Installation instructions (Figure 19).

SHIPPING PIN REMOVAL AND AIR LINE INSTALLATION

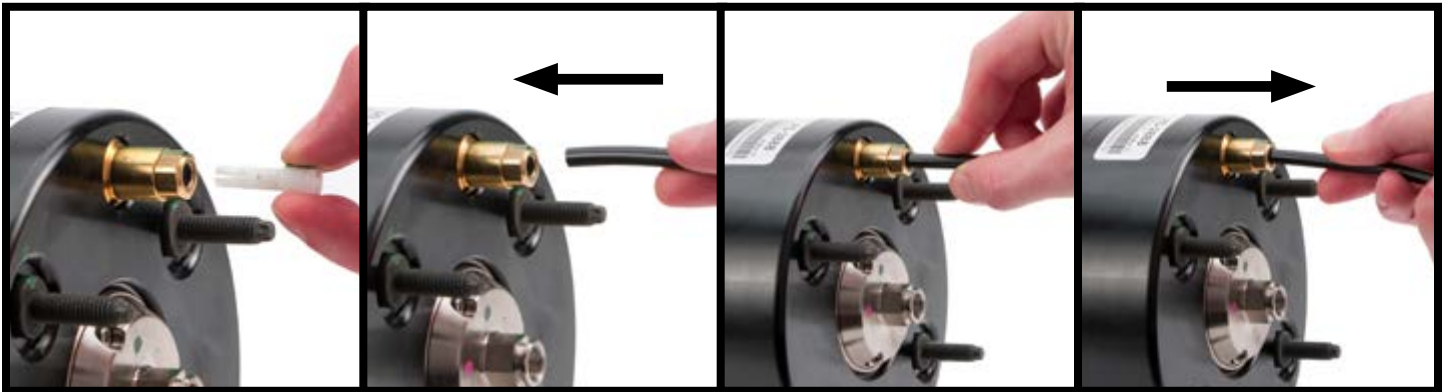

REMOVE AND DISPOSE OF THE SHIPPING PIN.

INSERT AIR LINE INTO THE AIR LINE FITTING UNTIL IT STOPS.

AIR LINE INSERTED.

GENTLY PULL ON AIR LINE TO CONFIRM IT IS FULLY SECURED BY THE AIR LINE FITTING.

FIGURE 19

Arnott®

Suspension Products

Arnott US Business Office:

www.arnottsuspension.com

100 Sea Ray Drive
Merritt Island, FL 32953

Call: 800.251.8993

321.868.3016

Fax: 321.868.3703

Email: techassistance@arnottinc.com

Arnott Europe Business Office:

www.arnotteurope.com

Industrieweg 19
5145 PD, Waalwijk (NL)

NL Phone: +31 73 7850 580

DE Phone: +31 85 2087 438

UK Phone: +44 203 3186 124

BE Phone: +32 258 846 90

ES Phone: +34 91 901 10 56

FR Phone: +32 78 48 46 93

Email: info@arnotteurope.com



HOW HELPFUL WAS THIS MANUAL?

Scan the QR code or click the link below to let us know.

<https://bit.ly/4rpiD4t>

NEED IMMEDIATE SUPPORT?

We're happy to help! Reach out using the contact information above.