

## TECHNICAL INFORMATION / INFORMACIÓN TÉCNICA INFORMATIONS TECHNIQUES / INFORMAÇÃO TÉCNICA

### 17-1081KSET B

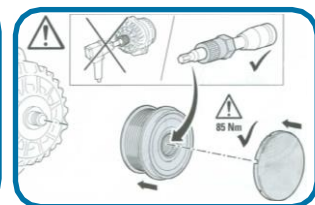
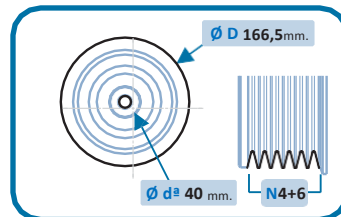

**ANTI-VIBRATION KIT composed of crankshaft pulley Ref. 17-1081 and alternator pulley Ref. 30-1041B, and bolt Ref. 50-1024**  
OEM → BMW: 11237788611 / 11237793593 / 11238511371

#### Assembly instruction:

This Crankshaft Pulley has been designed to work with the Overrunning Alternator Pulley Ref. 30-1041B.

**Failure to assemble the complete KIT will invalidate the warranty of your IJS GROUP product.**

Tighten the torque to 130 NM and tighten the screw 180º.

When changing the pulley, respect the direction, change the belts and adjust them to the correct tension.

ES

#### Instrucciones de montaje:

Esta polea del cigüeñal ha sido diseñada para funcionar con la polea libre del alternador Ref. 30-1041B.

**No montar el KIT completo invalidará la garantía de su producto IJS GROUP.**

Apriete el par a 130 NM y apriete el tornillo 180º.

Al cambiar la polea respetar la dirección, cambiar las correas y ajustarlas a la tensión correcta.

FR

#### Instructions de montage:

Cette poulie de vilebrequin a été conçue pour fonctionner avec la poulie d'alternateur à roue libre Réf. 30-1041B.

**Le fait de ne pas assembler le KIT complet annulera la garantie de votre produit IJS GROUP.**

Serrez le couple à 130 NM et serrez la vis à 180º.

Lors du changement de poulie, respectez le sens, changez les courroies et réglez-les à la bonne tension.

PT

#### Instrução de montagem:

Esta polia do virabrequim foi projetada para funcionar com a polia do alternador de ultrapassagem ref. 30-1041B.

**A não montagem do KIT completo invalidará a garantia do seu produto do GRUPO IJS.**

Aperte o torque a 130 NM e aperte o parafuso 180º.

Ao trocar a polia, respeite a direção, troque as correias e ajuste-as na tensão correta.



## Vehicle linkage and differences between 17-1081KIT A & 17-1081KIT B

### Aplicación vehículo diferencias entre 17-1081KIT A y 17-1081KIT B

### Affectation véhicule et différences entre 17-1081KIT A et 17-1081KIT B

### Vinculação do veículo e diferenças entre 17-1081KIT A e 17-1081KIT B

BMW				
Serie3 (E90)	325 d	197	M57 D30 (306D3)	09.2006 - 02.2010
Serie3 (E90)	330 d	231	M57 D30 (306D3)	09.2005 - 09.2008
Serie3 (E90)	330 xd	231	M57 D30 (306D3)	09.2005 - 08.2008
Serie3 Coupé (E92)	325 d	197	M57 D30 (306D3)	02.2007 - 02.2010
Serie3 Coupé (E92)	330 d	231	M57 D30 (306D3)	03.2006 - 08.2008
Serie3 Coupé (E92)	330 xd	231	M57 D30 (306D3)	03.2006 - 08.2008
Serie3 Coupé (E92)	335 d	286	M57 D30 (306D5)	03.2006 - 03.2013
Serie3 Descapotable (E93)	325 d	197	M57 D30 (306D3)	03.2007 - 12.2010
Serie3 Descapotable (E93)	330 d	231	M57 D30 (306D3)	03.2007 - 12.2013
Serie3 Touring (E91)	325 d	197	M57 D30 (306D3)	09.2006 - 06.2012
Serie3 Touring (E91)	330 d	231	M57 D30 (306D3)	12.2004 - 08.2008
Serie3 Touring (E91)	330 xd	231	M57 D30 (306D3)	09.2005 - 06.2012

BMW				
SerieX5 (E70)	3.0 d	235	M57 D30 (306D3)	12.2006 - 09.2008
SerieX5 (E70)	3.0 sd	286	M57 D30 (306D5)	10.2007 - 09.2008
SerieX5 (E70)	xDrive 30 d	235	M57 D30 (306D3)	10.2008 - 03.2010
SerieX6 (E71, E72)	xDrive 30 d	235	M57 D30 (306D3)	04.2008 - 03.2010
SerieX6 (E71, E72)	xDrive 35 d	286	M57 D30 (306D5)	01.2008 - 03.2010

**17-1081KIT A**

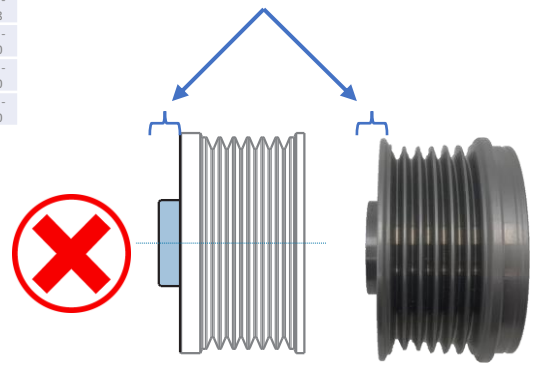

Ref. 30-1041A

BMW				
Serie3 (E46)	330 d	204	M57 D30 (306D2)	03.2003 - 02.2005
Serie3 (E46)	330 xd	204	M57 D30 (306D2)	09.2002 - 12.2004
Serie3 (E46)	330 xd	184	M57 D30 (306D1)	01.2000 - 02.2003
Serie3 (E90)	335 d	286	M57 D30 (306D5)	09.2006 - 12.2011
Serie3 Coupé (E46)	330 Cd	204	M57 D30 (306D2)	03.2003 - 07.2006
Serie3 Descapotable (E46)	330 Cd	204	M57 D30 (306D2)	08.2005 - 12.2007
Serie3 Touring (E46)	330 d	204	M57 D30 (306D2)	03.2003 - 02.2005
Serie3 Touring (E91)	335 d	286	M57 D30 (306D5)	09.2006 - 06.2012
Serie5 (E60)	525 d	197	M57 D30 (306D3)	01.2007 - 03.2010
Serie5 (E60)	525 d	177	M57 D25 (256D2)	06.2004 - 03.2010
Serie5 (E60)	525 d	163	M57 D25 (256D2)	12.2004 - 03.2010
Serie5 (E60)	525 d xDrive	197	M57 D30 (306D3)	09.2007 - 12.2009
Serie5 (E60)	525 xd	197	M57 D30 (306D3)	11.2006 - 08.2007
Serie5 (E60)	530 d	235	M57 D30 (306D3)	02.2007 - 12.2009
Serie5 (E60)	530 d	231	M57 D30 (306D3)	09.2005 - 03.2007
Serie5 (E60)	530 d	218	M57 D30 (306D2)	09.2002 - 09.2005
Serie5 (E60)	530 d	211	M57 D30 (306D2) M57 D30 (306D3)	09.2002 - 12.2009
Serie5 (E60)	530 d xDrive	235	M57 D30 (306D3)	09.2007 - 12.2009

BMW				
Serie5 (E60)	530 xd	235	M57 D30 (306D3)	03.2007 - 08.2007
Serie5 (E60)	530 xd	231	M57 D30 (306D3)	02.2005 - 02.2007
Serie5 (E60)	535 d	286	M57 D30 (306D5)	01.2007 - 03.2010
Serie5 (E60)	535 d	272	M57 D30 (306D4)	09.2004 - 03.2010
Serie5 Touring (E61)	525 d	197	M57 D30 (306D3)	03.2007 - 05.2010
Serie5 Touring (E61)	525 d	177	M57 D25 (256D2)	03.2004 - 03.2007
Serie5 Touring (E61)	525 d	163	M57 D25 (256D2)	03.2004 - 03.2007
Serie5 Touring (E61)	530 d	235	M57 D30 (306D3)	02.2007 - 05.2010
Serie5 Touring (E61)	530 d	231	M57 D30 (306D3)	02.2005 - 02.2007
Serie5 Touring (E61)	530 d	218	M57 D30 (306D2)	03.2004 - 09.2005
Serie5 Touring (E61)	530 d xDrive	235	M57 D30 (306D3)	09.2007 - 05.2010
Serie5 Touring (E61)	530 xd	235	M57 D30 (306D3)	03.2007 - 08.2007
Serie5 Touring (E61)	530 xd	231	M57 D30 (306D3)	02.2005 - 02.2007
Serie5 Touring (E61)	535 d	286	M57 D30 (306D5)	01.2007 - 12.2010
Serie5 Touring (E61)	535 d	272	M57 D30 (306D4)	09.2004 - 12.2010
Serie5 Touring (E61)	535 d	286	M57 D30 (306D5)	07.2007 - 07.2010
Serie6 (E63)	635 d	286	M57 D30 (306D5)	07.2007 - 07.2010
Serie6 Descapotable (E64)	635 d	286	M57 D30 (306D5)	07.2007 - 07.2010
Serie7 (E65, E66, E67)	730 Ld	231	M57 D30 (306D3)	07.2005 - 08.2008

BMW				
Serie7 (E65, E66, E67)	730 d	218	M57 D30 (306D2)	06.2002 - 02.2005
Serie7 (E65, E66, E67)	730 d	211	M57 D30 (306D2) M57 D30 (306D3)	09.2003 - 08.2008
SerieX3 (E83)	3.0 d	218	M57 D30 (306D3)	09.2005 - 08.2008
SerieX3 (E83)	3.0 d	204	M57 D30 (306D2)	01.2004 - 08.2005
SerieX3 (E83)	3.0 sd	286	M57 D30 (306D5)	09.2006 - 08.2008
SerieX3 (E83)	xDrive 30 d	218	M57 D30 (306D3)	09.2008 - 08.2010
SerieX3 (E83)	xDrive 30 d	211	M57 D30 (306D3)	09.2008 - 08.2010
SerieX5 (E53)	3.0 d	218	M57 D30 (306D2)	10.2003 - 09.2006

**Ref. 30-1041B**

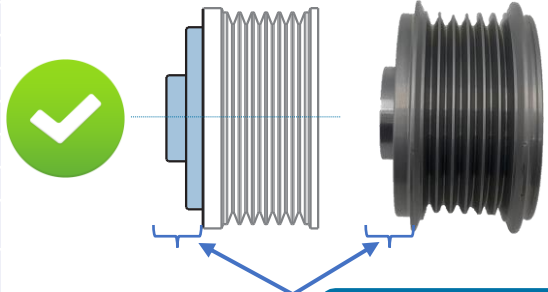

**17-1081KIT B**

